



Premier
Accommodation
Solutions

Available
Nationwide



A wide range of site accommodation, available for long & short term hire.

**Available
Nationwide**

We are delighted to add the provision of secure accommodation solutions to our product range, including portable offices, canteens, welfare units and drying rooms.

Our anti-vandal steel cabin units are designed to give peace of mind with regards to security. They are robust, portable and are designed to withstand wear & tear on the outside whilst providing comfort on the inside. Call us today to learn more about our growing range of accommodation options.

20ft x 8ft Anti Vandal Office

- 2no Doubled Glazed Windows c/w Steel Shutters
- Standard Furniture Package – 2no Desks & 2no Soft Chairs
- 1no Multi Point Locking Steel Entrance Door
- 32Amp 240 Volt Inlet Plug
- Data Inlet Connection
- 3no Double 13amp Sockets 2 of which have USB charging
- 1no Single 13amp Socket
- 2no Led Strip Lights
- 1no Oil Filled 750 Watt Energy Efficient Heater
- 2no Notice Boards
- 1no Coat & Hat Rail
- Black Anti Slip Vinyl Flooring
- White GRP easy clean walls & ceiling
- High Density Insulation

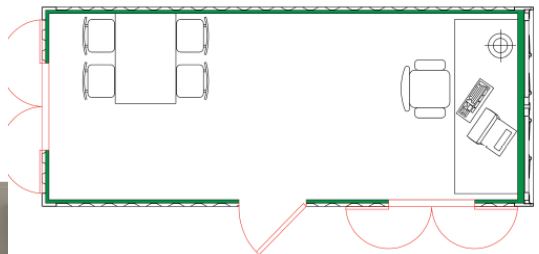

20ft x 8ft Anti Vandal Canteen

- 2no Doubled Glazed Windows c/w Steel Shutters
- 1no Multi Point Locking Steel Entrance Door
- 32Amp 240 Volt Inlet Plug
- Fresh Water & Waste Water Connections
- Data Inlet Connection
- Stainless Steel Sink Unit with Hot Water Tap
- 2no Double 13amp Sockets with USB charging
- 2no Led Strip Lights
- 1no Oil Filled 750 Watt Energy Efficient Heater
- 2no Notice Boards
- 1no Coat & Hat Rail
- Black Anti Slip Vinyl Flooring
- White GRP easy clean walls & ceiling
- High Density Insulation
- Standard Furniture Package – 1no Canteen Table & 8no Canteen Chairs

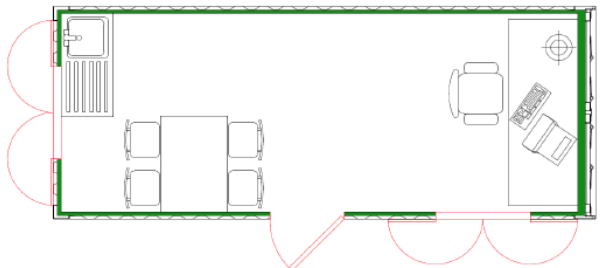

20ft x 8ft Anti Vandal Toilet Block

Single cell, 2
cell and 4 cell
toilet units
also available

- 5no Multi Point Locking Steel Entrance Doors
- Fresh Water & Waste Water Connections
- Rodding Eyes
- 4no Unisex Single WC's, all with Hand Dryers, Sinks, Hot Water, Heating & PIR lights
- 1no Urinal Trough with Hand Dryers, Sinks, Hot Water, Heating & PIR Lights
- 3000 Litre Internal Effluent Tank or Mains Connection
- Red & Amber Tank Level Indicators
- Telematics available on request to manage tank cleaning
- Thermostatically Controlled Blown Air Heating
- Black Anti Slip Vinyl Flooring
- White GRP easy clean walls & ceiling
- High Density Insulation

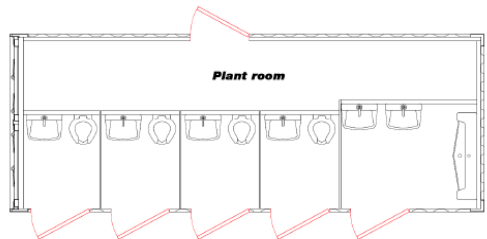

20ft x 8ft Anti Vandal Drying Room

- 2no Doubled Glazed Windows c/w Steel Shutters
- 1no Multi Point Locking Steel Entrance Door
- 32Amp 240 Volt Inlet Plug
- Data Inlet Connection
- 2no Long Double Bench Seats c/w Hat & Coat Hooks
- 3no Double 13amp Sockets 2 of which have USB charging
- 1no Single 13amp Socket
- 2no Led Strip Lights
- 1no Oil Filled 750 Watt Energy Efficient Heater
- 2no Notice Boards
- Black Anti Slip Vinyl Flooring
- White GRP easy clean walls & ceiling
- High Density Insulation

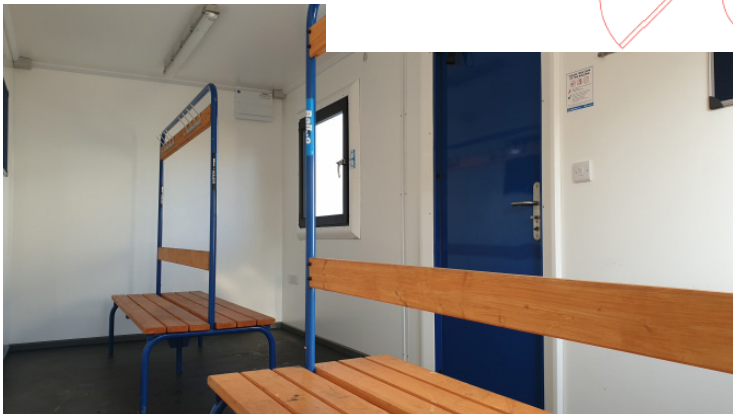
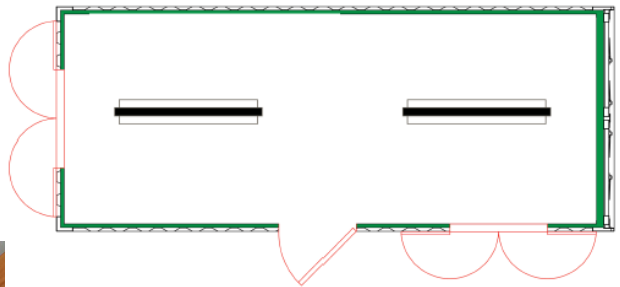

EcoSmart Welfare Unit

Eco
Friendly

- Mobile self contained welfare facilities, ideal for any size or type of site.
- Efficient Eco smart technology
- Powerful Economical Generator
- Easy to move
- No nonsense 30 second Set up
- Fully insulated wall and roof system with no cold bridging
- PIR activated LED lighting & hot water without the need for the generator
- Low noise pollution
- Low fuel consumption
- Low CO2 emissions
- Automatic generator timed shut off for unnecessary fuel usage
- Low energy LED road lights



Compound Set Up

- For larger sites, there is also an option for a Compound set up
- Lift Plans available



Also Available

- Security Huts
- Storage containers 10 x 8 ft and 20 x 8 ft for safe storage of tools on site

